

RoHS Compliant

THIS DRAWING CONTAINS INFORMATION THAT IS PROPRIETARY TO ZDT TECHNOLOGY, AND SHOULD NOT BE USED WITHOUT WRITTEN PERMISSION

REV	ECN No.	DATE	REMARK
A0	NEW	2018.08.12	NEW RELEASE

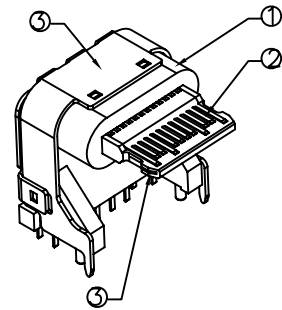
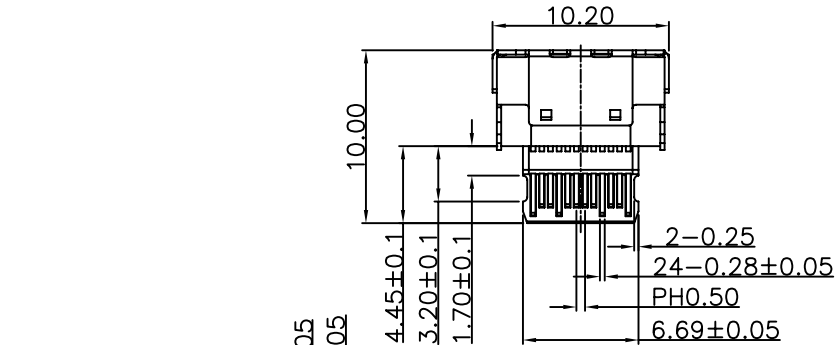

- NOTES:
- MATERIAL: SEE "TABLE 1";
 - FINISH: SEE "TABLE 1";
 - ELECTRICAL :
 - CONTACT CURRENT RATING :
5A(VBUS PIN 1.5A/PIN),
5A(GND PIN 1.25A/PIN MAX),0.25A/PIN(OTHER PIN).
 - INSULATION RESISTANCE :
100 MEGAOHMS MIN. AT 250VDC.
 - DIELECTRIC WITHSTANDING VOLTAGE :
100VAC MIN.
 - LOW LEVEL CONTACT RESISTANCE :
INITIAL 40mΩ MAX.
AFTER 50mΩ MAX.
 - MECHANICAL CHARACTERISTICS :
 - MATING FORCE: 5~20N.;
 - UNMATING FORCE: 8~20N(INITIAL),
6~20N(AFTER 10000 CYCLES);
 - DURABILITY : 10,000 MATING CYCLES.
 - OPERATING TEMPERATURE :-40°C TO +80°C

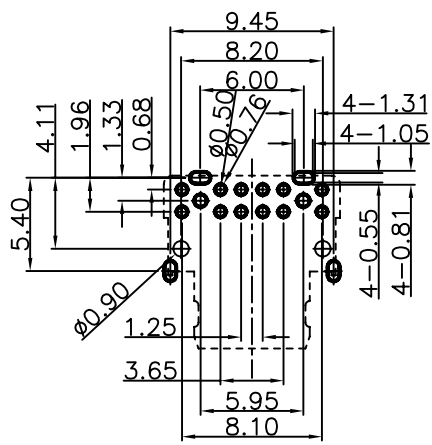
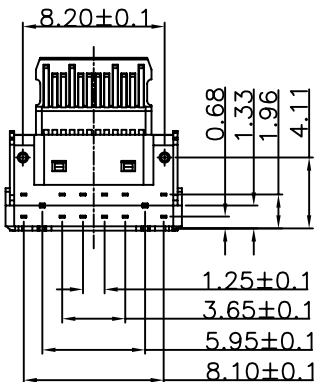
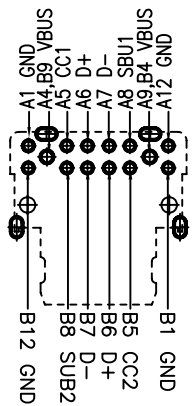
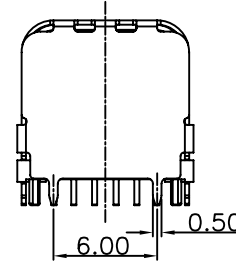
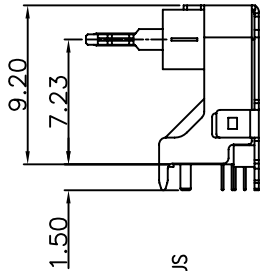
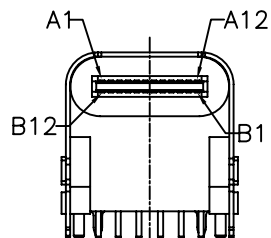
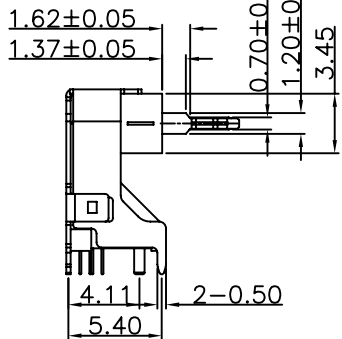

P.C.B LAYOUT

TABLE 1:

CF189-16SLW11T-D	④	Shell	1	Stainless steel	NI PLATING;	T=0.25mm
	③	MID PLATE	1	Stainless steel		T=0.15mm
	②	Terminal	24	7025	Au:15u" PLATING;	T=0.12mm
	①	Housing	3	HIGH TEMP	White	
PART NO.	NO.	PART NAME	QTY	MATERIAL	DESCRIPTION	REMARK

PART NO.: SEE THE PART NUMBER CODE		深圳市中兴兴达科技有限公司 SHENZHEN ZDT TECHNOLOGY CO.,LTD		DRAWN BY SAM	DATE 2018.08.12
GENERAL TOLERANCES (UNLESS SPECIFIED)		TITLE TYPE CF 16PIN DIP加高型		CHECKED BY JAY	DATE 2018.08.12
QUALITY SYMBOL	0 = Δ	x.xxxx	+	APPROVED BY JACKY	DATE 2018.08.12
	0 = ▽	x.xxx	± 0.10		
	0 = ▽	x.xx	± 0.25		
	0 = ▽	x.x	± 0.30		
	0 = ▽	ANGULAR	+		
DWG.NO. CF189-24-D1		SHEET NO. 1 OF 1		SCALE 1:1	
DIMENSION STYLE MM ONLY		DESIGN UNITS METRIC		THIRD ANGLE PROJECTION	