

RoHS Compliant 

THIS DRAWING CONTAINS INFORMATION THAT IS PROPRIETARY TO ZDT TECHNOLOGY, AND SHOULD NOT BE USED WITHOUT WRITTEN PERMISSION

| REV | ECN No. | DATE | REMARK |
|-----|---------|------------|-------------|
| A | NEW | 2020.10.25 | NEW RELEASE |

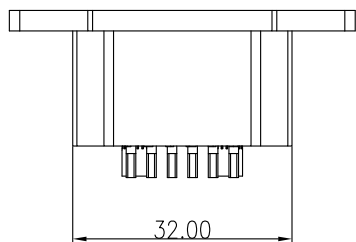
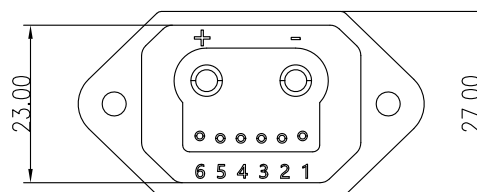
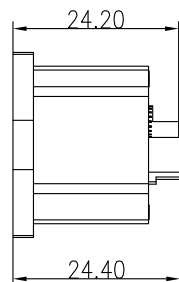
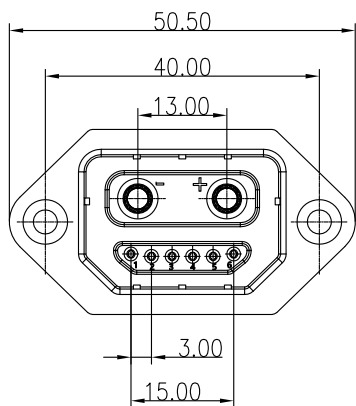
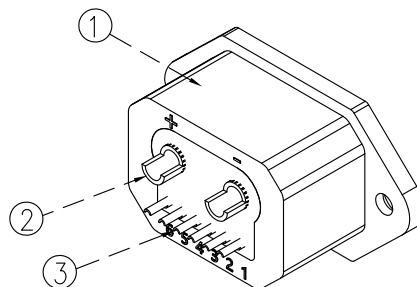
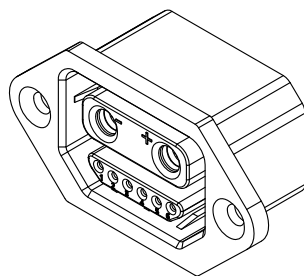
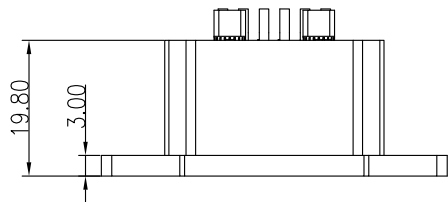

NOTES:

1. MATERIAL: SEE "TABLE 1";
2. FINISH: SEE "TABLE 1";
3. ELECTRICAL:
 - 3.1. VOLTAGE RATING: 48V DC
 - 3.2. CURRENT RATING: 50A
 - 3.3. CONTACT RESISTANCE: 50mΩ Max.
 - 3.4. INSULATION RESISTANCE: 500 MΩ Min.
 - 3.5. WITHSTAND VOLTAGE: 500 VAC Min.
4. MECHANICAL:
 - 4.1. OPERATING LIFE: 5000 CYCLES MIN.;

TABLE 1:

| NO. | PART NAME | QTY | MATERIAL | DESCRIPTION |
|-----|------------------|-----|--------------|---|
| ③ | The signal PIN | 6 | Copper Alloy | Ni 50u" Min |
| ② | Power supply PIN | 2 | Copper Alloy | Au G/F Min on contact area, All over Ni 50u"Min |
| ① | Housing | 1 | HIGH TEMP | BLACK |

| | | | | | |
|---|---------------------------------------|---|----------------------------|------------------------|--------------------|
| PART NO.: PWF001-B11T-J6 | |  深圳市中科兴达科技有限公司 SHENZHEN ZDT TECHNOLOGY CO., LTD | | DRAWN BY SAM | DATE 2020.10.25 |
| QUALITY SYMBOL 0 0 0 0 0 | GENERAL TOLERANCES (UNLESS SPECIFIED) | | TITLE 6+2新能源车连接器母座 | | |
| | x.xxxx | ± --- | DWG.NO. PWF001-J6 | SHEET NO. 1 OF 1 | CHECKED BY JAY |
| | x.xxx | ± 0.15 | | | DATE 2020.10.25 |
| | x.xx | ± 0.25 | APPROVED BY JACKY | DATE 2020.10.25 | |
| | x.x | ± 0.30 | DIMENSION STYLE MM ONLY | | SCALE 1:1 |
| ANGULAR | ± ---° | DESIGN UNITS METRIC | | THIRD ANGLE PROJECTION | |