

| REV | ECN No. | DATE | REMARK |
|-----|---------|------------|-------------|
| A | NEW | 2023.05.25 | NEW RELEASE |

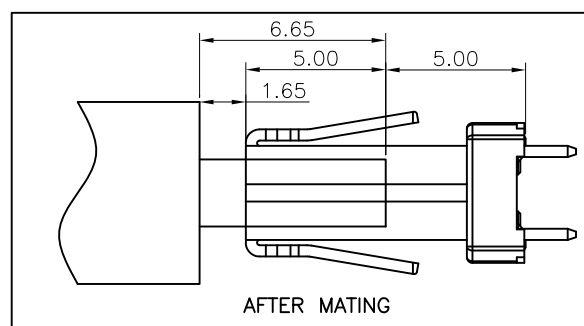
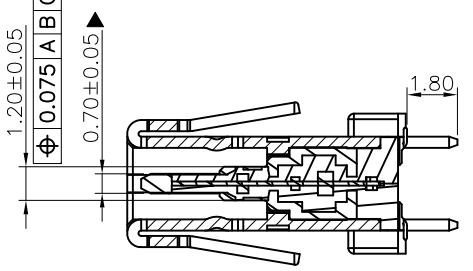
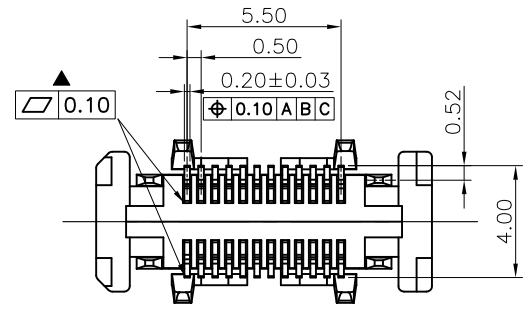
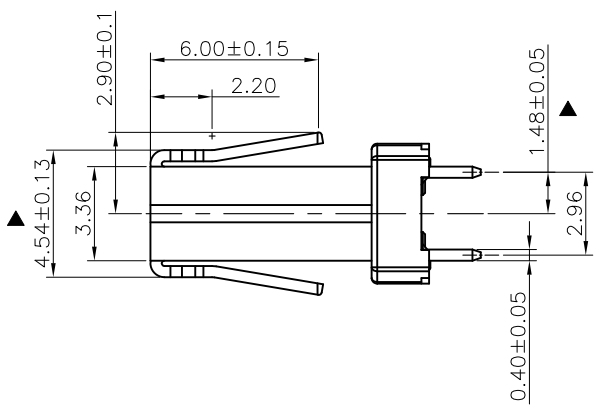
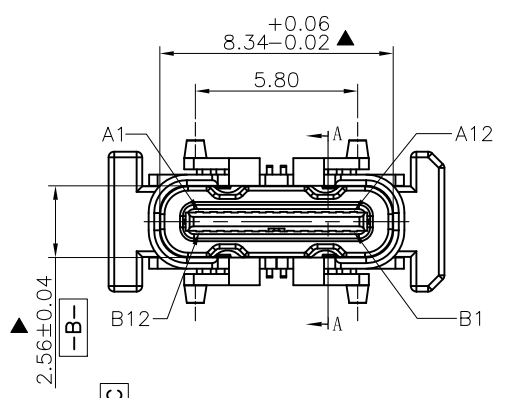
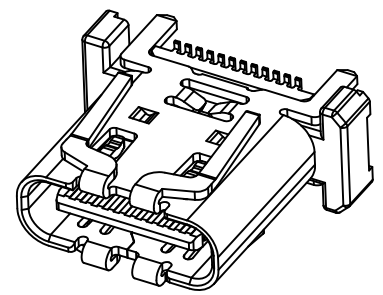
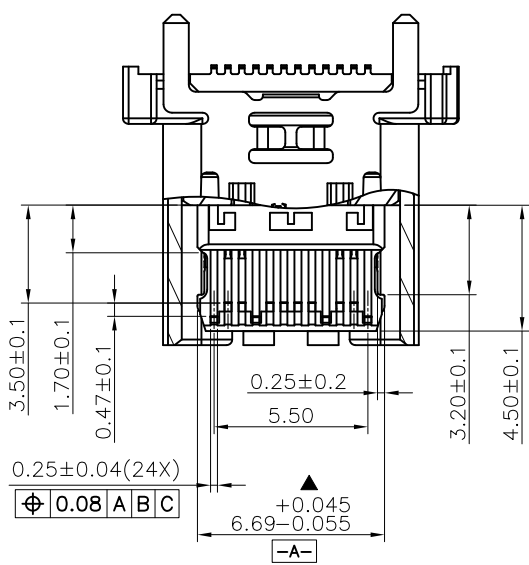
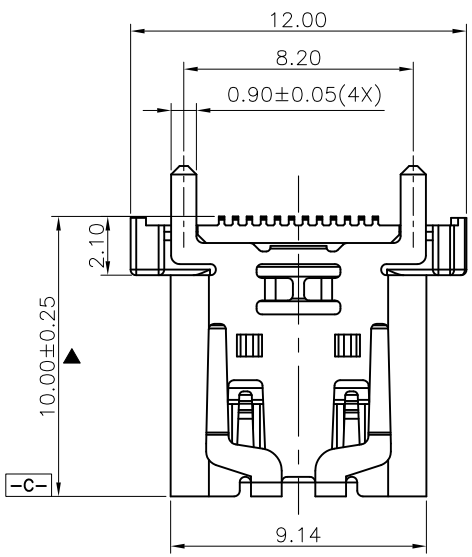

PIN DEFINITION:

| PIN No. | A1 | A2 | A3 | A4 | A5 | A6 | A7 | A8 | A9 | A10 | A11 | A12 |
|-------------|-----|------|------|------|------|----|----|------|------|------|------|-----|
| SIGNAL NAME | GND | TX1+ | TX1- | VBus | CC1 | D+ | D- | SBU1 | VBus | RX2- | RX2+ | GND |
| PIN No. | B12 | B11 | B10 | B9 | B8 | B7 | B6 | B5 | B4 | B3 | B2 | B1 |
| SIGNAL NAME | GND | RX1+ | RX1- | VBus | SBU2 | D- | D+ | CC2 | VBus | TX2- | TX2+ | GND |

TABLE:

| NO | PART | Q'TY | Material |
|----|-----------|------|---|
| 1 | SHELL | 1 | STAINLESS STEEL 304, NI 50u" MIN PLATED |
| 2 | Mid Plate | 1 | STAINIESS STEEL 301, NO PLATED |
| 3 | CONTACT | 24 | COPPER ALLOY C18150,Au Plated On Vontact Area GF Plated On Solder Area;Nickel 50u"Min Underplating Over All. |
| 4 | HOUSING | 1 | PA9T BLACK UL94 V-0 |

PART NO.: SEE THE PART NUMBER CODE
 GENERAL TOLERANCES: x.xxxx ± ---
 x.xxx ± 0.10
 x.xx ± 0.25
 x.x ± 0.30
 ANGULAR ± 3'

DRAWN BY: HuangXiaoHao
 CHECKED BY: liuzongliang
 APPROVED BY: Jacky

THIRD ANGLE PROJECTION

| DIMENSIONS | SCALE | DRAWING | SHEET NO. | DWG.NO. |
|------------|-------|---------|-----------|--------------|
| mm | 1:1 | A4 | 1 OF 2 | CF124-019-01 |

TITLE: USB TYPE-C 24P 直立式H=10.0四脚插板外壳带弹

ZDT 深圳市中科兴达科技有限公司
SHENZHEN ZDT TECHNOLOGY CO.,LTD

| | | | |
|-----|---------|------------|-------------|
| REV | ECN No. | DATE | REMARK |
| A | NEW | 2023.05.25 | NEW RELEASE |

NOTE:

1.ELECTRICAL PERFORMANCE,
1-1. CURRENT RATING:5 AMPS. FOR TOTAL VBUS/GND PINS;
1.25AMPS FOR CC PIN,
0.25 AMPS. FOR ALL OTHER CONTACT.
1-2. VOLTAGE RATING:20V DC/AC (RMS. MAX)
1-3. LLCR:.
VBUS & GND PINS AND OTHER PINS: 40MΩ/PIN MAX.
SHIELD:50MΩ/MAX.
LLCR MAX. CHANGE OF ALL PINS: 10MΩ.
1-4.INSULATION RESISTANCE: 100MΩ MIN
1-5.DIELECTRIC WITHSTAND VOLTAGE,AC 100V FOR 1 MINUTE.

2.MECHANICAL PERFORMANCE,
2-1.INSERTION FORCE: 5~20N.
2-2.EXTRACTION FORCE: 8~20N.
2-3.DURABILITY: 10000 CYCLES.

3.ENVIRONMENTAL PERFORMANCE:
OPERATING TEMPERATURE: -25°C~+85°C.

4.IR REFLOW:
THE PEAK TEMPERATURE ON THE BOARD SHALL
BE MAINTAINED FOR 10 SECONDS AT 260°C.

5.COMPLIANCE WITH ROHS REQUIREMENTS.

6.SALT SPRAY:48H

7. With "▲" for the key control size

6.PART NUMBER CODE:

CF 1 24 - 019 S C B 12 R - 01

PACKING OPTIONS:
R:TAPE & REEL

CONTACTS PLATED:
12:Contact Area: Au 3u"
Solder Tails:GF

HOUSING COLOR:
B:BLACK

HOUSING MATERIALS:
C:PA9T

Pin No.:
24:24Pin

Product type:
1:VERTICAL

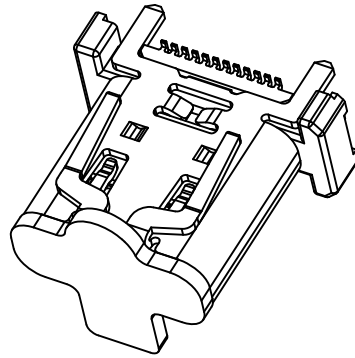
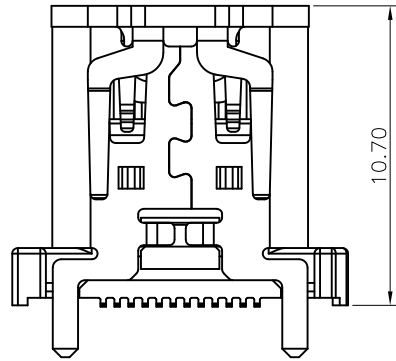
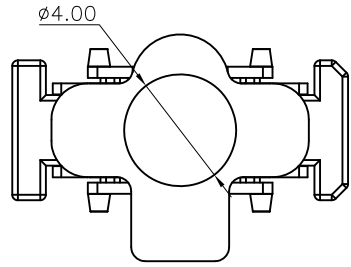

ASSEMBLY WITH COVER

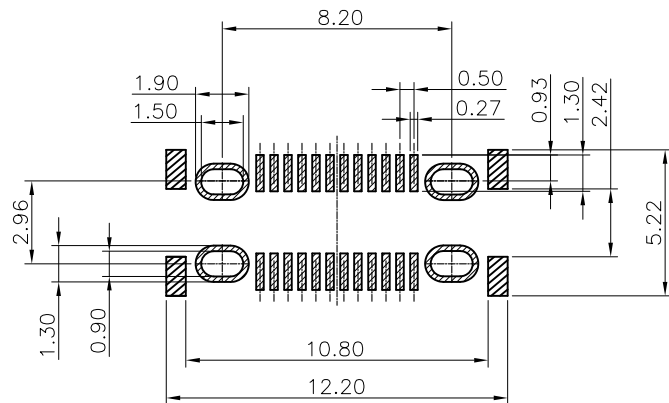

RECOMMENDED PCB LAYOUT(TOP VIEW)
THICKNESS 1.0±0.10MM;DEFAULT TOLERANCE:±0.05

| | | | | | |
|--------------------------|--------|------------------------|--|--|--------------|
| PART NO.: | | DRAWN BY: | | 深圳市中科兴达科技有限公司 SHENZHEN ZDT TECHNOLOGY CO.,LTD | |
| SEE THE PART NUMBER CODE | | HuangXiaoHao | | | |
| GENERAL TOLERANCES | | CHECKED BY: | | TITLE USB TYPE-C 24P直立式H=10.0四脚插板外壳带弹 | |
| x.xxxx | ± --- | liuzongliang | | | |
| x.xxx | ± 0.10 | APPROVED BY: | | | |
| x.xx | ± 0.25 | Jacky | | | |
| x.x | ± 0.30 | THIRD ANGLE PROJECTION | | DIMENSIONS | |
| ANGULAR | ± 3' | | | SCALE | DRAWING |
| | | | | 1:1 | A4 |
| | | | | SHEET NO. | DWG.NO. |
| | | | | 2 OF 2 | CF124-019-01 |